

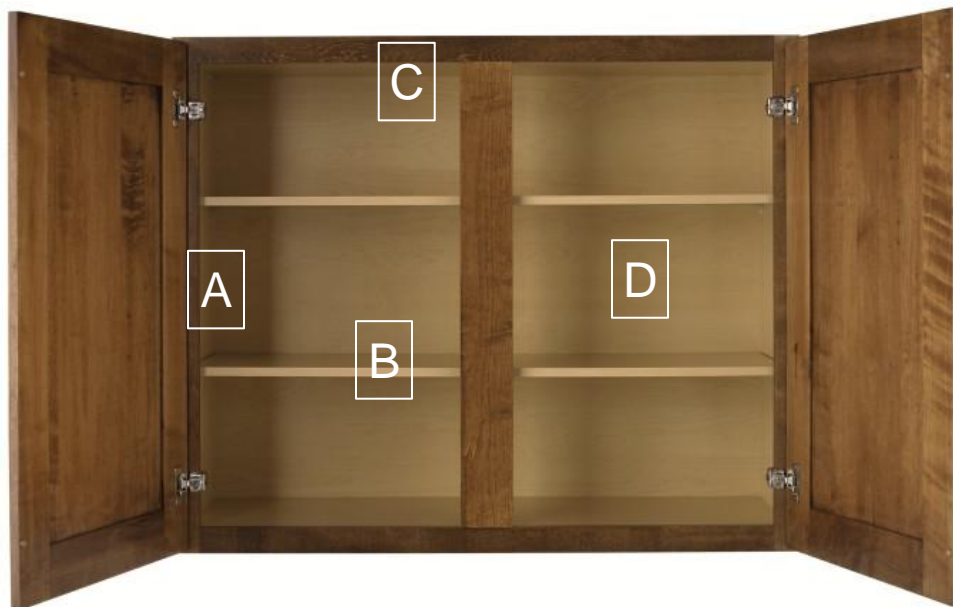

Aristokraft
CABINETRY

Construction Review

- A. 3/8" thick furniture board sides with matching exterior laminate
- B. 1/2" thick furniture board adjustable wall shelves
- C. 1/2" thick furniture board top & bottom
- D. 3/8" thick furniture board back



Butt Door Option for Selected Styles Only

- Standard on cabinets 27" to 36" wide in all categories
- ¾" thick shelving on all wall cabinets featuring butt doors
- 6-way adjustable hinging featured on all cabinets
- Center mullion eliminated on Wall Open units



- A. 3/8" thick furniture board sides with matching exterior laminate
- B. 1/2" thick furniture board half depth shelf
- C. 3/8" thick furniture board bottom
- D. 3/8" thick furniture board back
- E. Four furniture board corner braces



Butt Door Option for Selected Styles Only

- Standard on cabinets 27" to 36" wide in all categories
- Base cabinetry features 1 wide drawer
- 6-way adjustable hinging featured all most cabinets



- A. 3/8" thick furniture board sides with matching exterior laminate
- B. 3/4" thick furniture board adjustable wall shelves
- C. 1/2" thick furniture board top and bottom
- D. 3/8" thick furniture board back

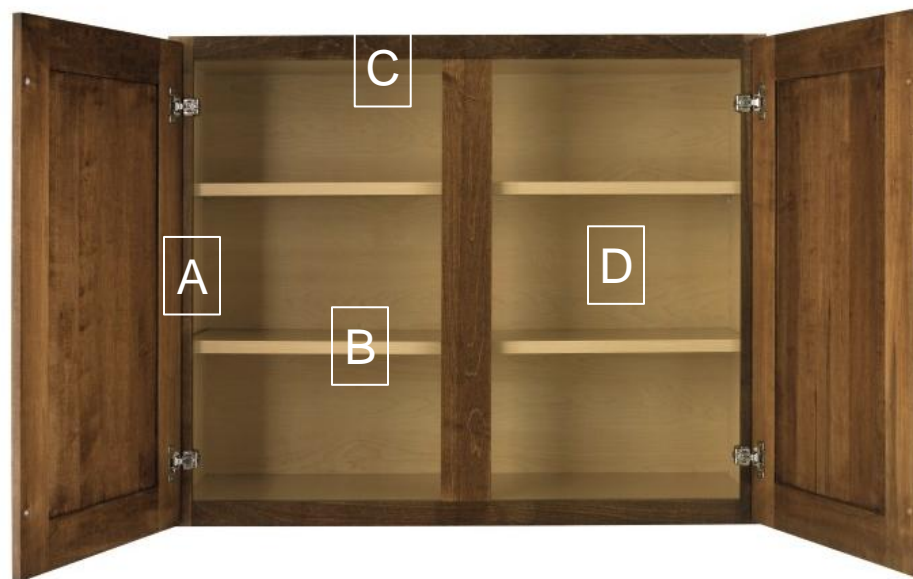

- A. 3/8" thick furniture board sides with matching exterior laminate
- B. 1/2" thick furniture board half depth shelf
- C. 3/8" thick furniture board bottom
- D. 3/8" thick furniture board back
- E. 3/8" thick x 4" high furniture board recessed toekick



- A. 3/8" thick **plywood** sides with finished veneer exterior
- B. 3/4" thick **plywood** adjustable wall shelves
- C. 1/2" thick **plywood** top and bottom
- D. 3/8" thick **plywood** back

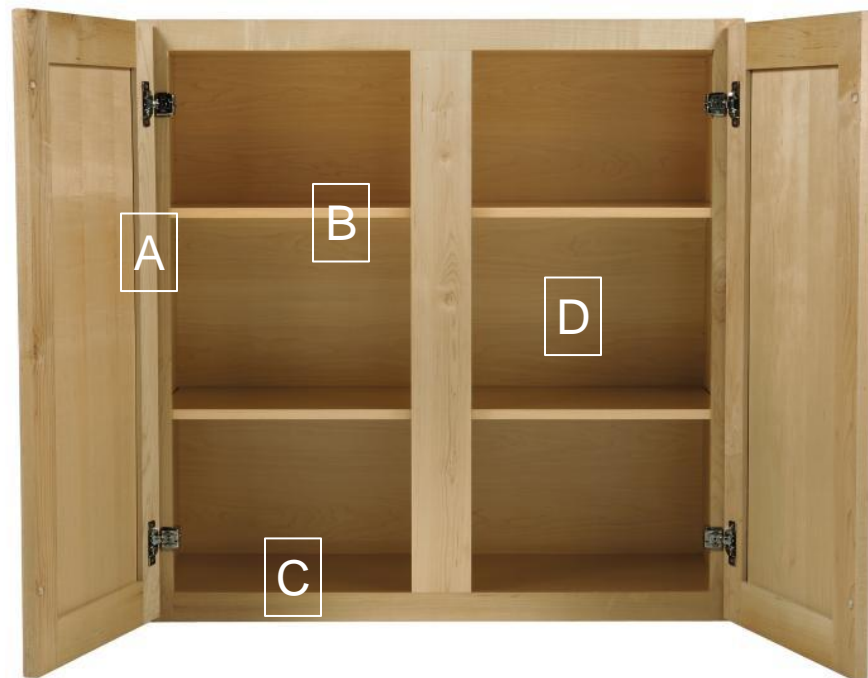

- A. 3/8" thick **plywood** sides with finished veneer exterior
- B. 1/2" thick **plywood**, half-depth base shelf
- C. 3/8" thick **plywood** back and bottom
- D. (4) **plywood** corner braces
- E. 3/8" thick x 4" high unfinished **plywood** toekick

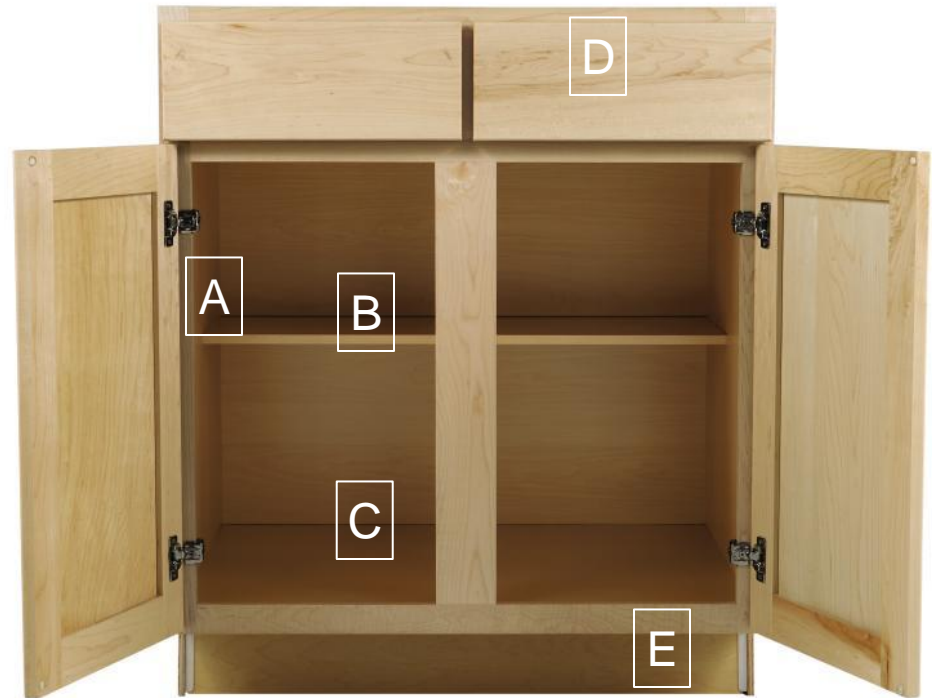

The cabinet interior of all Aristokraft construction platforms features Aristex® natural maple laminate, except White styles, which feature Aristex® white laminate.



Aristokraft
CABINETRY

Aristex® Interior

- A. ½” thick furniture board sides, front and back
- B. Self-closing, side mount, epoxy-coated drawer guides for smooth, quiet action. Rated at 100 lbs. capacity per drawer.
- C. 3/8” thick furniture board drawer bottom with Aristex® laminate finish fastened into sides, front and back.



- A. ¾" thick all-wood dovetailed drawer sides, front and back with clear topcoat.
- B. Undermount, self-closing, epoxy-coated drawer guides for smooth, quiet action. Rated at 100 lbs. capacity per drawer.
- C. ¼" thick plywood drawer bottom, fully captured for added strength and optimum load capacity.

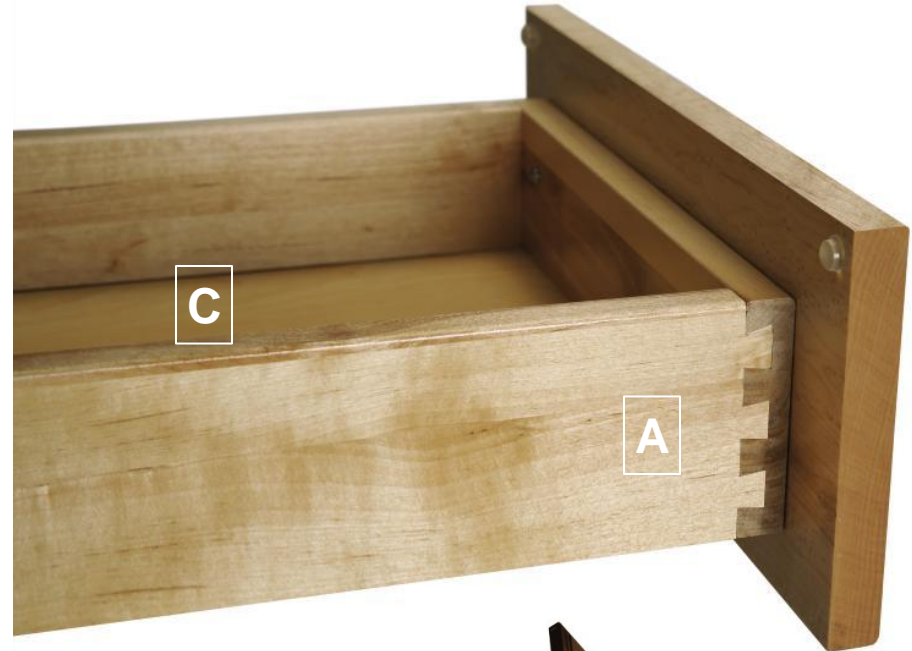

Concealed Full Extension drawer glides with Smart Stop available for Select & All Plywood construction options only.

- To order Smart Stop FX Drawer Guide Upgrade, add “FX” after the product code (i.e. B18FX, DB18FX, etc.)



**Drawer Upgrade
Full Extension with Smart Stop**

We're so proud of the Aristokraft brand that we display our logo in the top drawer of every base cabinet.

- This will help customers continue to identify with the fine quality and craftsmanship of our cabinetry.

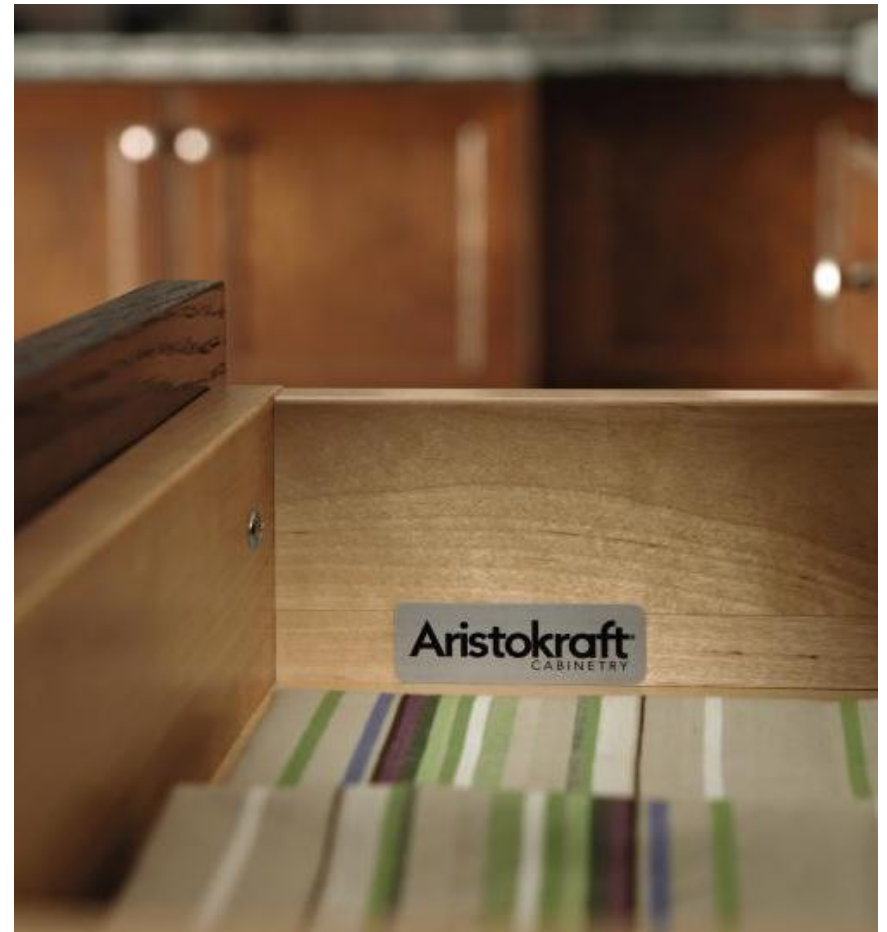

Aristokraft®
Drawer Label

Aristokraft's doors are mounted on fully concealed self-closing, adjustable steel hinges.

- Hinges and hardware are chosen for reliability and beauty.
- Full overlay styles feature 6-way adjustable hinges.



Aristokraft Cabinetry is a certified brand in the Kitchen Cabinet Manufacturers Association (KCMA) Environmental Stewardship Program. The program recognizes companies that demonstrate an ongoing commitment to environmental practices and sustainability.



Aristokraft
CABINETRY

**KCMA Environmental
Stewardship**

Aristokraft participates in the voluntary certification program of the Kitchen Cabinet Manufacturer's Association and has completed rigorous battery of tests simulating years of typical household use. Tests are performed by approved third-party independent laboratories.



Aristokraft cabinets have a **five-year warranty** on all workmanship and manufacturing defects, and a **lifetime limited warranty** on all drawer glides and hinges.





Aristokraft
CABINETS

Thank You!